

HAUPTGEBÄUDE

main building

Tiefparterre / lower ground floor

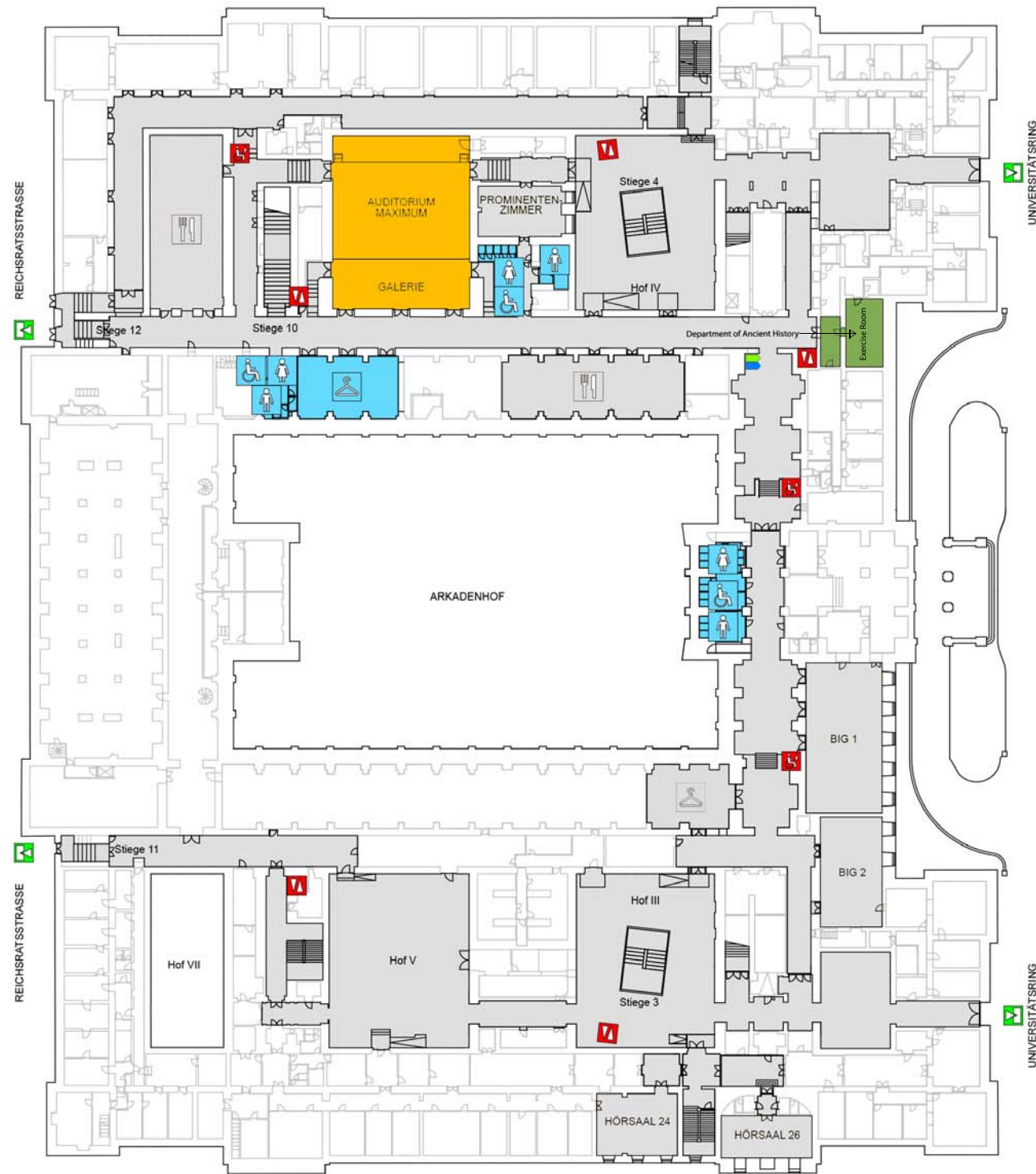

0 10 20 30 m



-  Ausgang
Exit
-  Aufzug
Elevator
-  Treppenlift
Stair Elevator
-  WC Damen
Ladies
-  WC Herren
Men
-  Behinderten-WC
Disabled
-  Portier
Information Desk
-  Veranstaltungsflächen
Event Areas
-  Supporträume
Support Areas
-  Gastronomie
Food & Beverages
-  Garderobe
Cloakroom
-  Bankomat
ATM/ Cash Dispenser

HAUPTGEBÄUDE

main building

Hochparterre / raised ground floor

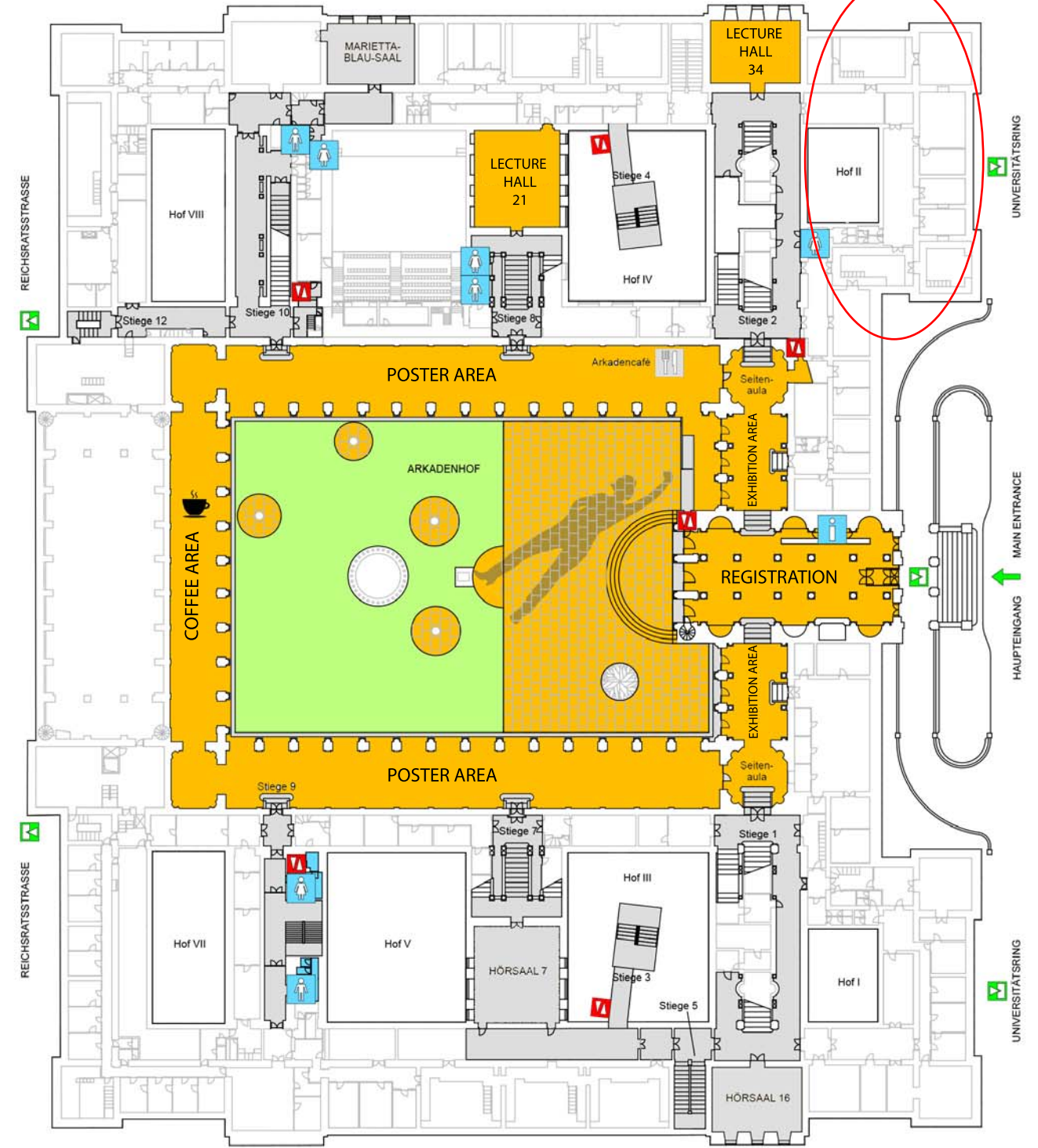

0 10 20 30 m



-  Ausgang
Exit
-  Aufzug
Elevator
-  WC Damen
Ladies
-  WC Herren
Men
-  Behinderten-WC
Disabled
-  Portier
Information Desk
-  Veranstaltungsflächen
Event Areas
-  Supporträume
Support Areas
-  Gastronomie
Food & Beverages
-  Garderobe
Cloakroom